

Exhibit #22 Preliminary Wetland Delineation

PITTMAN ENVIRONMENTAL SERVICES, LLC

June 13, 2011

Mr. Brendon E. Gaspard, P.E.
Pan American Engineers- Alexandria, Inc.
1717 Jackson Street
Alexandria, LA 71301

RE: Preliminary Wetland Delineation
148± Acres, Town of Bunkie
Avoyelles Parish, LA

Dear Mr. Gaspard:

As requested, a preliminary wetland delineation has been conducted for the above referenced property. Based upon careful review of all available data and an onsite inspection, approximately 0.1 acres of jurisdictional wetland was delineated within limits of site. Approximately 3,500 LF of ditch located within and adjacent to the site could potentially be jurisdictional "waters of the U.S.". The attached report describes the results of the preliminary study.

This delineation is preliminary; it is the responsibility of the New Orleans District Army Corps of Engineers to issue a final jurisdictional determination. I will await your notice to proceed in sending a copy of this report with data sheets to the COE for final determination.

If you have any questions, or need additional information please contact me at (601) 297-2487.

Sincerely,



Bart A. Pittman
Environmental Specialist

**Preliminary Wetland Delineation
148± Acres, Town of Bunkie
Avoyelles Parish, Louisiana**

**Prepared By
Pittman Environmental Services, L.L.C.
June 10, 2011**

At the request of the Pan American Engineers-Alexandria, Inc., a preliminary wetland delineation has been conducted for approximately 148 acres located in Sections 30 and 43, Township 1 South, Range 3 East, Avoyelles Parish Louisiana. The subject property is located adjacent LA Highway 115 within the Town of Bunkie. Attached maps show the exact location and extent of delineated parcel. This report will describe the results of a preliminary wetland delineation conducted for the said property to determine the presence and approximate extent of jurisdictional wetlands and "waters of the U.S." as defined in Section 404 of the Clean Water Act. Pan American Engineers-Alexandria, Inc. requested the preliminary wetland delineation, and the onsite inspection was conducted by Mr. Bart Pittman on June 2, 2011.

SITE DESCRIPTION

The subject property consists of a 148± acre parcel located adjacent to the south of LA Hwy. 115 within the Town of Bunkie. The Avoyelles Realty Subdivision borders site to the east. The entire subject parcel and majority of adjacent property is comprised of agricultural land currently established with row crop (soy bean). A strip of wooded area and ditch borders site to the west. Manmade drainage ditches border and transect the subject property. Hydrology within property drains to the centrally located ditch, which drains to the ditch along western property line. The NRCS Web Soil Survey indicates the mapped soil type within site as Coughatta silt loam (Nd & Nr), a non-hydric soil. The mapped units (Nd & Nr) were formerly classified as Norwood silt loam. The NRCS Web Soil Survey soil map of property is shown in **Attachment 1**. Pictures (**Attachment 2**) depict the current state of the site and surrounding properties.

METHODOLOGY

Methods utilized for identifying and delineating wetlands follow procedures outlined in Part IV of the "Corps of Engineers Wetlands Delineation Manual" dated January 1987 and the Atlantic/Gulf Cost Plain Regional Supplement. Wetland Delineation Data Forms (Atlantic and Gulf Cost Plain Region) were completed for each vegetative community represented within the project. These attached data forms (**Attachment 3**) provide a

Preliminary Wetland Delineation
148± Acres, Town of Bunkie
Avoyelles Parish, Louisiana
Page 2

listing of parameters/indicators to differentiate jurisdictional wetlands from non-wetlands. The completed forms confirm the presence or absence of required wetland criteria; hydrophytic vegetation, wetland hydrology, and hydric soils. The approximate location of each data point is shown on the attached preliminary wetland delineation map, (**Attachment 1**).

Initial review of the subject property indicated that site is well drained and has been subject to continuous crop rotation for many years. Manmade drainage features are located adjacent site with one feature/ditch transecting length of site east to west. The entire site was transected and observed for visual indicators of jurisdictional wetland. Soil profiles were examined throughout site for indicators of hydrology and hydric soil.

RESULTS

Approximately 0.1 acres of the site was delineated as jurisdictional wetland. Approximately 3,500 LF of drainage ditch located within/adjacent to site was delineated as potentially jurisdictional "other waters of the U.S.". Additional drainage ditch is located adjacent to property boundaries. The location and dimensions of each feature are provided on attached preliminary wetland delineation map, (**Attachment 1**).

Delineated Wetland

One wetland/drain feature is located at the southwest corner of property. This feature is a narrow vegetated drain adjacent to ditch. This feature has an area of approximately 0.1 acres within site. Dominant vegetation within feature includes hackberry (*Celtis laevigata*), palmetto (*Sabal minor*), and ragweed (*Ambrosia spp.*). One culvert outfalls into feature from site.

Drainage Ditch

One ditch transects the center of site for approximately 2,750 LF flowing east to west. This manmade ditch was created to remove storm water from surrounding area. At time of visit this ditch was inactive with no flow or saturation within channel. This ditch appears to be active for brief periods following heavy rain events. One data point was

Preliminary Wetland Delineation
148± Acres, Town of Bunkie
Avoyelles Parish, Louisiana
Page 3

recorded within bottom of ditch. This ditch has an average top-bank width of approximately 21' and OHW width of 8'. This ditch drains to the "north/south" ditch located along the western property line. This ditch was also apparently created to remove storm water from surrounding area. The ditch located along the western property line ($\pm 2,524$ LF) has an average top-bank width of approximately 27' and OHW width of 20'. At time of visit some inundation was observed within southern limits of ditch. The "north/south" ditch does appear to be active for extended periods during the year.

Roadside ditch and smaller field ditch borders the subject property. The location of this ditch and direction of drainage is shown on attached map. With exception of the "north/south" ditch, all drainage features were created within areas on non-wetland/non-hydric soil.

Row Crop

The entire site is currently planted with row crop (soy bean). Soil profiles within site exhibited a "high" chroma matrix of 5 YR 4/3. Hydrology and hydric soil indicators were absent within row crop.

CONCLUSION

Based upon careful review of all available data and an onsite inspection, approximately 0.1 acres of the site was delineated as jurisdictional wetland. Approximately 3,500 LF of drainage ditch located within/adjacent to site was delineated as potentially jurisdictional "other waters of the U.S.". is shown on the preliminary wetland delineation map, **Attachment 1**. The attached wetland delineation data forms (**Attachment 3**) confirm the conclusion of the preliminary study, indicating the presence or absence of sufficient wetland criteria at each sample point.

This wetland delineation is preliminary and should not be interpreted as a final determination. The responsibility of a final wetland determination is that of the U.S. Army Corps of Engineers, New Orleans District.

ATTACHMENT 1
MAPS

148+/- Acre Tract Located Within Sections 30 & 43,
T-1S, R-3E, Avoyelles Parish, LA



Pittman Environmental Services LLC

TOPO! map printed on 08/11/11 from "Untitled.tpo"

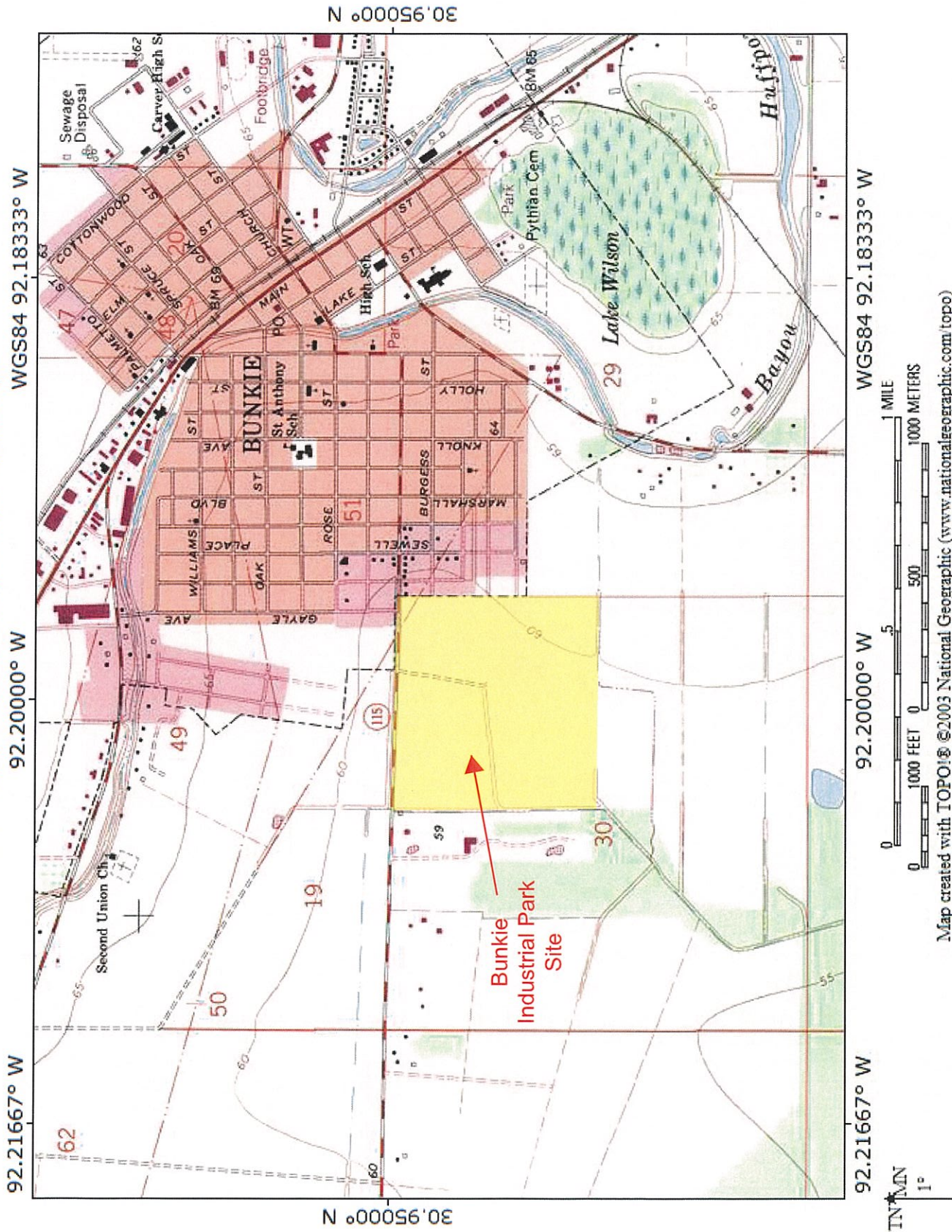



U.S. Fish and Wildlife Service

National Wetlands Inventory

148 Ac. Site

Jun 10, 2011

Wetlands

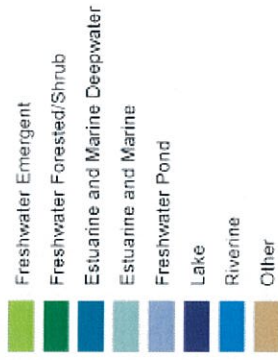

This map is for general reference only. The US Fish and Wildlife Service is not responsible for the accuracy or completeness of the data shown on this map. All wetlands related data should be used in accordance with the layer metadata found on the Wetlands Mapper web site.

User Remarks: